

A large radio telescope dish is positioned in the foreground, angled upwards. The background is a clear night sky filled with stars and the prominent band of the Milky Way galaxy. The scene is set in a snowy, mountainous landscape under a dark sky.

# Space station (AGP)

The English School of Gothenburg

# Target

- In space there isn't much to do and you might not even be able to have your own space which could be suffocating, so we have decided that everyone deserves to have their own space even astronauts, they would probably like that because they have their the bedrooms for the astronauts are going to include bed which will be accessible for zero gravity so we will have thick tight straps which you can easily strap yourself into when you want to go to sleep or are lying in bed, the room will have plants in it so that it will produce enough oxygen that you need. In the station the different rooms will be bathroom(for obvious reasons), bedroom(everyone will have their own room so that they can sleep peacefully, kitchen(to warm make and eat food, lounge(when they all want to just chill together this room will include a screen, two big sofas and a small table) and others rooms in the space station because they will be up in space for a long time they need to feel as much as on earth as they are in space.

# What we need to survive!

For us to breathe we need oxygen or we can't live and without it we would die. Plants produce oxygen for our world so for our space station we are going to make a mini indoor forest , because it is very useful so its important to have plants and trees so we can breath. We also need food and water and to keep us healthy. That is also why we have a big water tank under our space station that you can refill and a lot of food so we don't die . We need also need a toilet and a bedroom for us to fill comfortable. We need a shower too because if we don't have any shower we would get really dirty and smelly and you can become really sick if you don 't.

# Extra Features

If you go to space, then you must do other entertainments apart from researching and discovering space because it will not be fun to be up there somewhere not knowing what to do. If there somehow were fun activities...

Idea 1: Have a book between every room. This book is like a door, you turn the page to open and turn it back to close. This will prevent astronauts from being bored and bringing tons of books since one page is big in area and has a lot of words.

Idea 2: A great place to meditate and have peace. A forest in the middle of space! This forest will have many different types of plants, trees and other natural living beings. Not only can you be alone, but you can also have good oxygen and very cleaned air. The forest will be in a glass room so that the plants get light and grow healthy and strong. The room will also have an automatic watering system so that they don't dry out.

Idea 3: If it got too hot or too cold in the space station it would probably not be a bad idea to have a main control or have some air conditioning going on and be able to control them.



# Here are our pictures of ideas!

(The size of our space station (in scale) is 50m wide and 75m tall!)

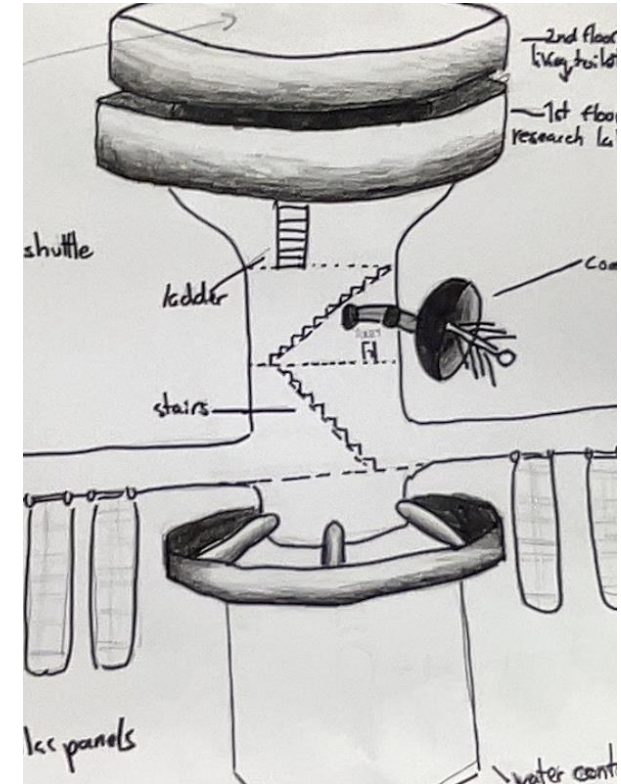
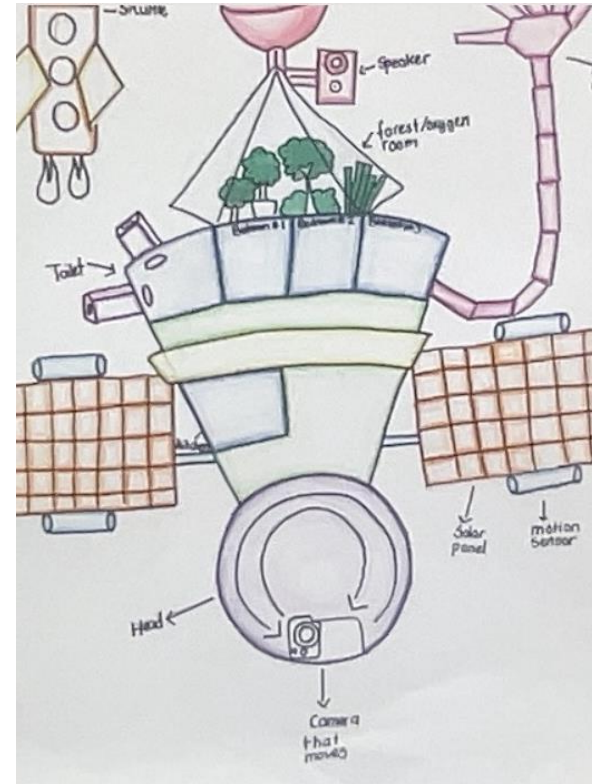
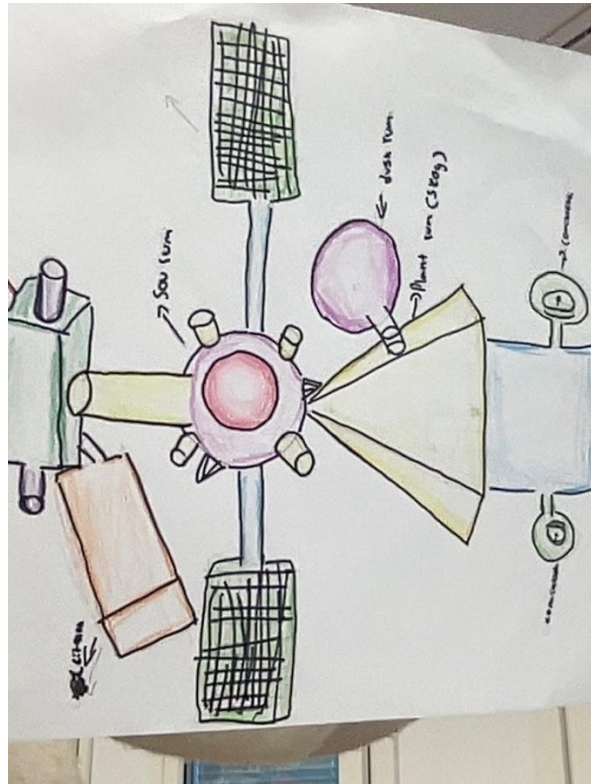
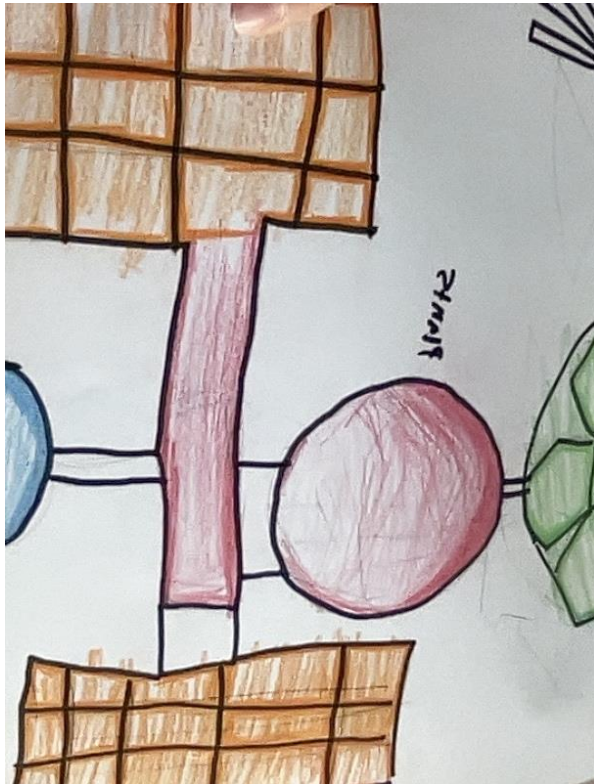



# Experiment

Our experiment and main reason were going up there is that we have a forest on top of the space station. Our (totally only) issues are that this "forest" obviously require plants to call it a forest which require earth AND water to grow.

Issue 1: Since there is no gravity in space the earth or soil will float around making sandstorm which we do not want. You could grow grass over it but then the soil is still not stuck to anything so that that won't work unless you could maybe water the soil which would make it heavy but then again, we don't have the water supply.





# Photos of what we have done so far!



# Our process!

- Today we started building and split up the work so each of us could work with something different so it was quicker. One of us started with the main area/ the floor where the astronauts sleep so he cut out two cardboard circles that were around 20 by 20 cm and then cut a strip of cardboard to join the circles in a thick circle shape, he then did that again so we have two big circles that we will use for that area. Whilst he was doing that another one of us were making the part to connect the hole space station and we used big and small straw and taped them together and then I did a few and then I took all that we did and taped it all together and on the side. We also had someone making our indoor forest and she used a type of clear hard plastic for the shape of the square based pyramid she cut out one square and four triangles and glued the bottom together but left the top open so she could make trees, for the trees we used coloured tissue paper as leaves and had brown paper as the stem. We then glued that inside of the pyramid



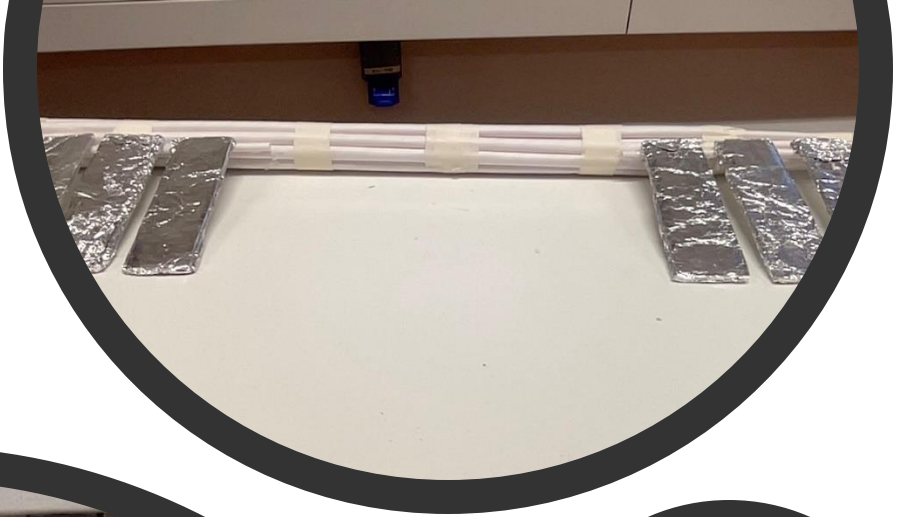

Photos on the second week of building!



# What we did this lesson

- This week we made solar panels to put on the base. We glued together the main base, and we made a communication thing that is in the middle of the space station. Our space station will have a rocket or a shuttle so that we can transport fresh water and other things or food for in case we run out for emergency 's. Some members have finished with our experiment which is bringing and looking if plants survive in space.

# What we hope to achieve next lesson

- We are going to have a lesson where we paint all the object and pieces that we need it on, we will also put together all the pieces so that we have our shapes glued together after that we will just be adding finishing touches.



# What can you experience in our space station

- in our space station you can have and do many things, so that you can live and feel the same way as you would live in your home. There is a gym to train and a forest on the top of our space station. In this forest you can take a break and breath in new fresh air or just hang out with somebody and enjoy this cool experience!

# Final Model

---

